

# Pond Decant Kit

Pond Decant Kits are installed in Decanting Earth Bunds or Sediment Retention Ponds. They allow the clean water on the top of the pond to flow at a controlled rate through the pond or bund wall to be released into the waterway.

## KIT INCLUDES >

- 1 Pond Decant T Bar 110mm **Code: 13015**
- 2 Pond Decant T Bar 40mm **Code: 13016**
- 3 Flexible Coupling 110mm **Code: 13283**
- 4 Pond Extension 1.8m **Code: 13194**  
(2 per Decant T-Bar)
- 5 Anti-Seep PVC Collar 100mm **Code: 13401**  
Anti-Seep PVC Collar 150mm **Code: 13402**  
Anti-Seep PVC Collar 350mm **Code: 13403**
- 6 Steel Y Posts 1.5m **Code: 76058**  
(6 per Decant Pond Kit)
- 7 Safety Caps 100/Bag **Code: 76059**
- 8 PVC Plain 100mm T Junction **Code: 13316**  
PVC Plain 150mm T Junction **Code: 13317**
- 9 PVC Plain 100mm Y Joiner **Code: 13502**
- 10 150mm-110mm Reducer **Code: 13224**
- 11 Danline Rope Black 4mm x 220m **Code: 13195**

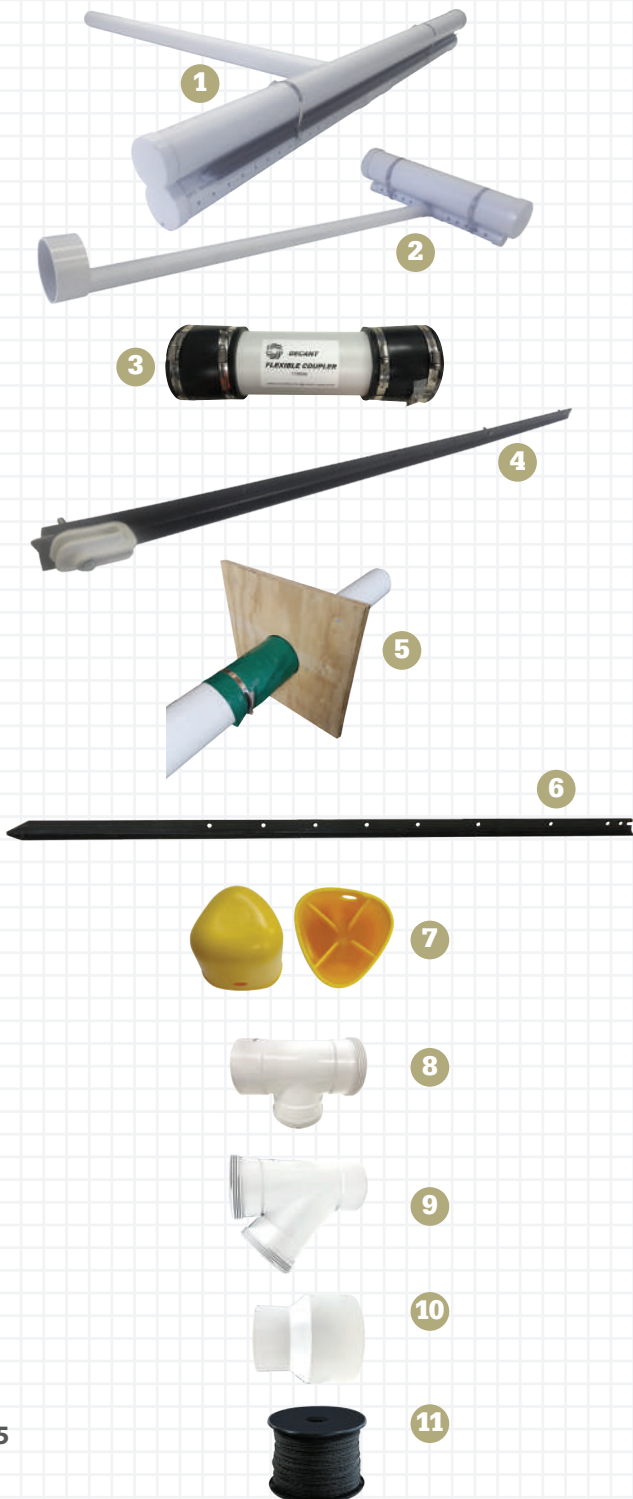







# Pond Decant 110mm System

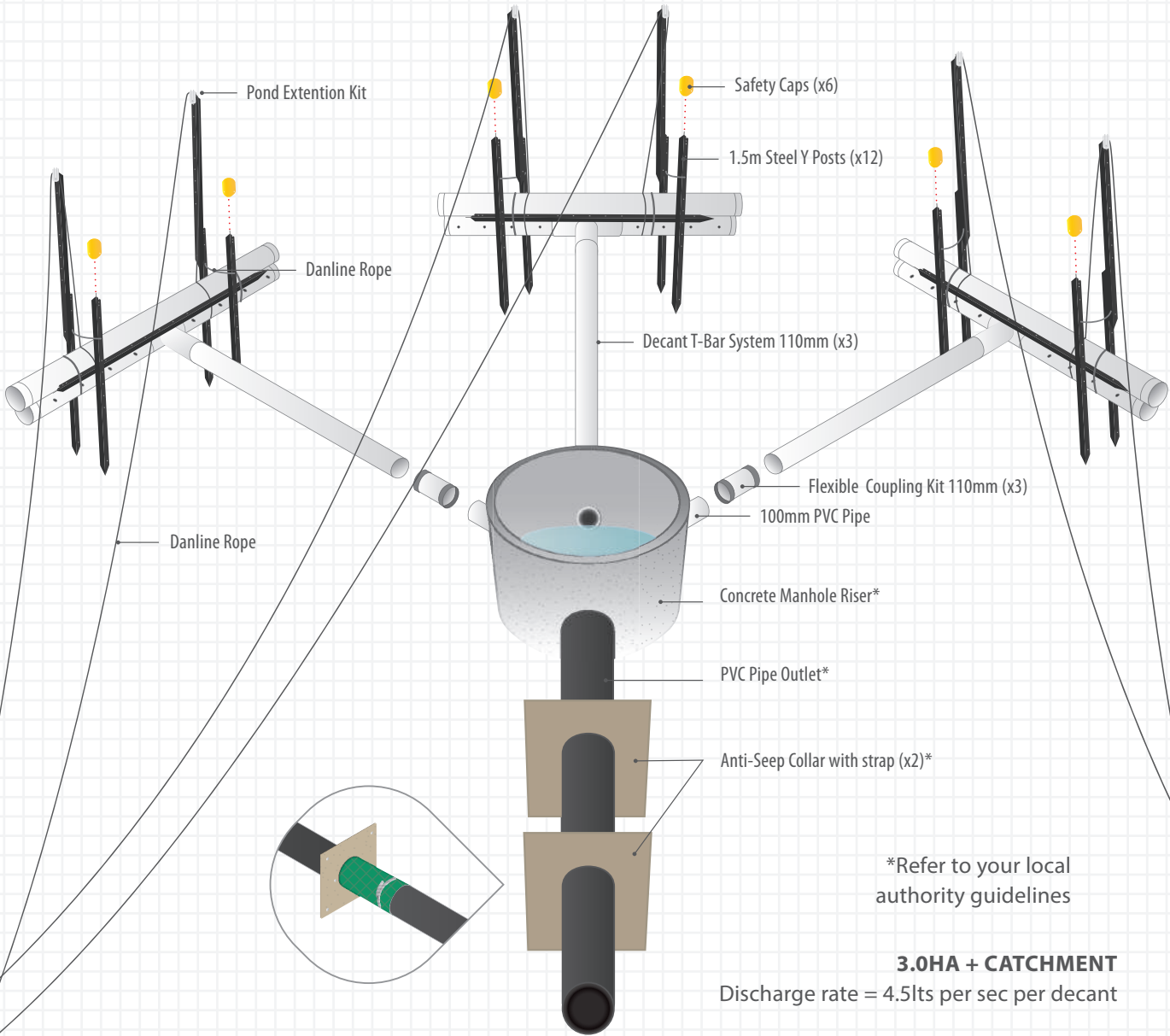

## ALSO REQUIRED >

- ✓ EnviroForce
- ✓ DuraForce® WG21
- ✓ Ground Staples 230mm
- ✓ 110mm PVC (customer supply)

## Decant Pond 110mm Components

Code	Product	Size	Qty Req.
13015	Pond Decant T Bar	110mm	3
13283	Flexible Coupling Kit	110mm	3
13194	Pond Extension Kit	1.8m	6
13403	Anti-Seep Collar	350mm	2
76058	Steel Y Posts	1.5m	12
76059	Safety Caps	100/Bag	1
13195	Danline	4mm	1

# Decant Y System

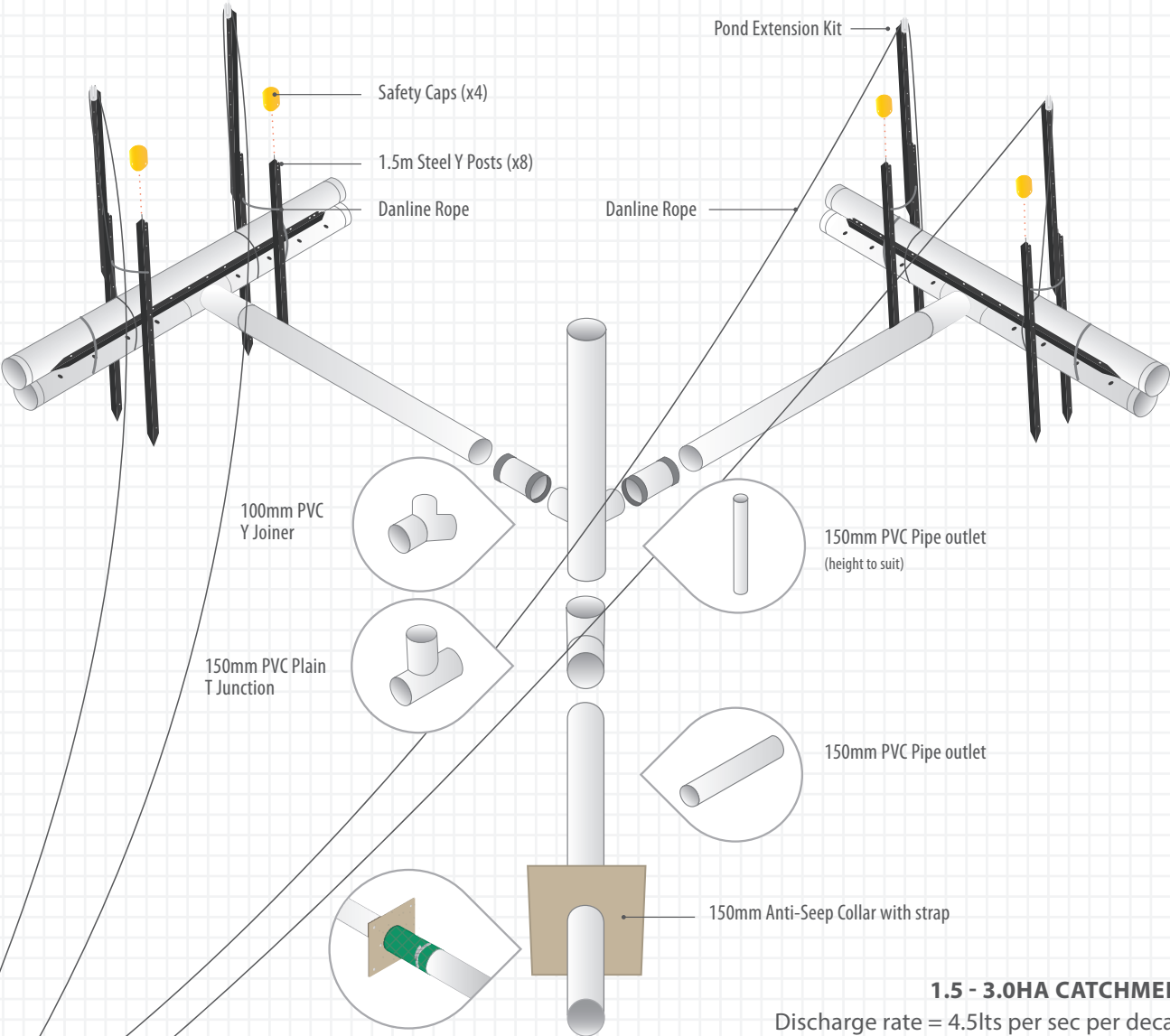

**1.5 - 3.0HA CATCHMENT**  
Discharge rate = 4.5lts per sec per decant

**ALSO REQUIRED >**

- ✓ DuraForce® WG21
- ✓ Ground Staples 230mm
- ✓ 150mm PVC (customer supply)

**Decant Pond 110mm Components**

Code	Product	Size	Qty Req.
13015	Pond Decant T Bar	110mm	2
13283	Flexible Coupling Kit	110mm	2
13194	Pond Extension Kit	1.8m	4
13402	Anti-Seep Collar	150mm	1
76058	Steel Y Posts	1.5m	8
76059	Safety Caps	100/Bag	1
13502	PVC Y Joiner	100mm	1
13317	PVC Plain T Junction	150mm	1
13195	Danline 4mm	220m	1



TO ORDER CALL US ON  
**0800 CIRTEX (247 839)**

# Decant Kit 110mm

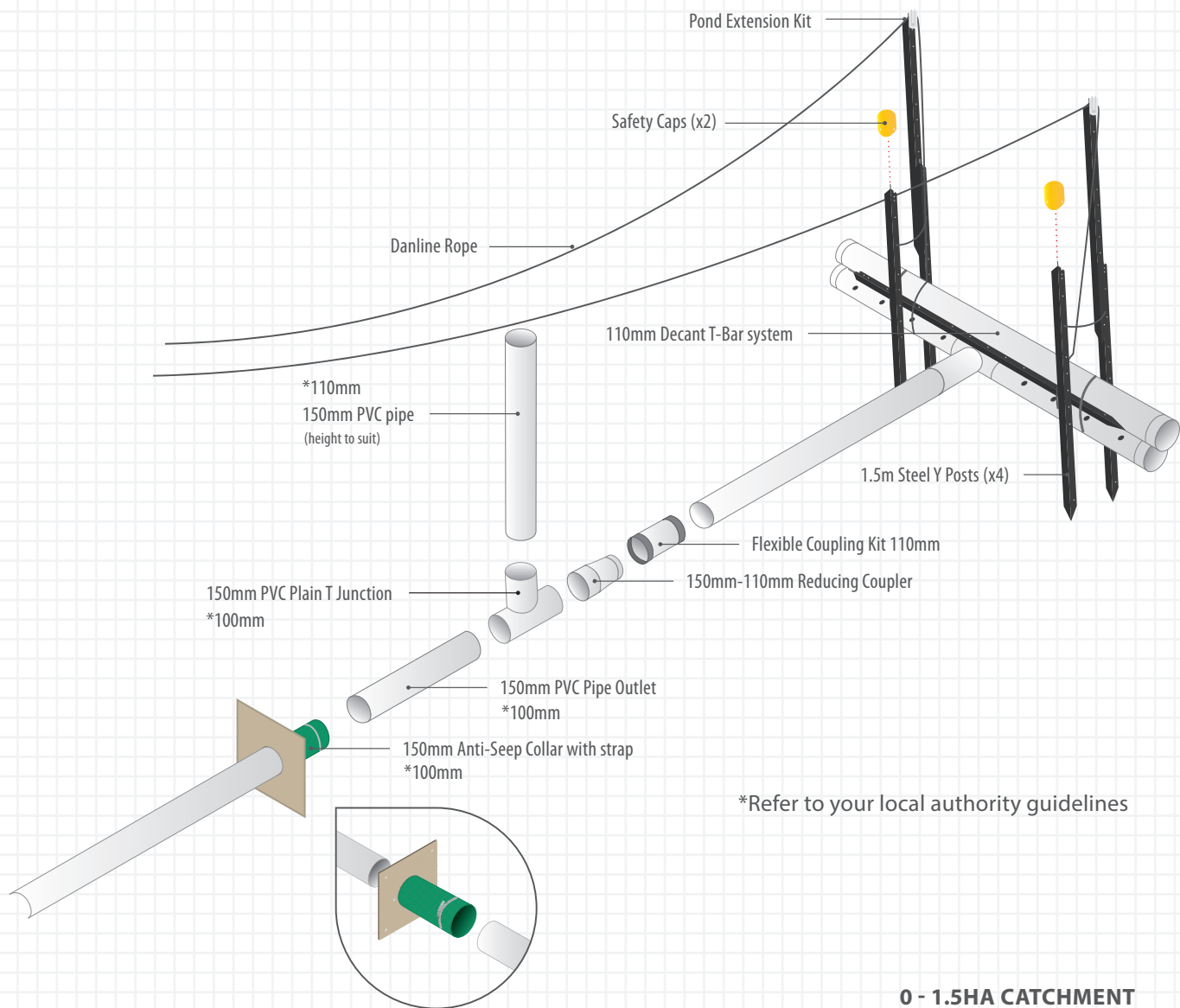

**0 - 1.5HA CATCHMENT**  
Discharge rate = 4.5ltrs per sec

## ALSO REQUIRED >

- ✓ EnviroForce
- ✓ DuraForce® WG21
- ✓ Ground Staples 230mm
- ✓ 110mm PVC (customer supply)

### Decant Kit 110mm Components

Code	Product	Size	Qty Req.
13015	Pond Decant T Bar	110mm	1
13283	Flexible Coupling Kit	110mm	1
13194	Pond Extension Kit	1.8m	2
13402	Anti-Seep Collar	150mm	1
76058	Steel Y Posts	1.5m	4
76059	Safety Caps	100/Bag	1
13317	PVC Plain T Junction	150mm	1
13224	Reducing Coupler	150mm x 110mm	1
13195	Danline	4mm 220m	1

# Decant Kit 40mm

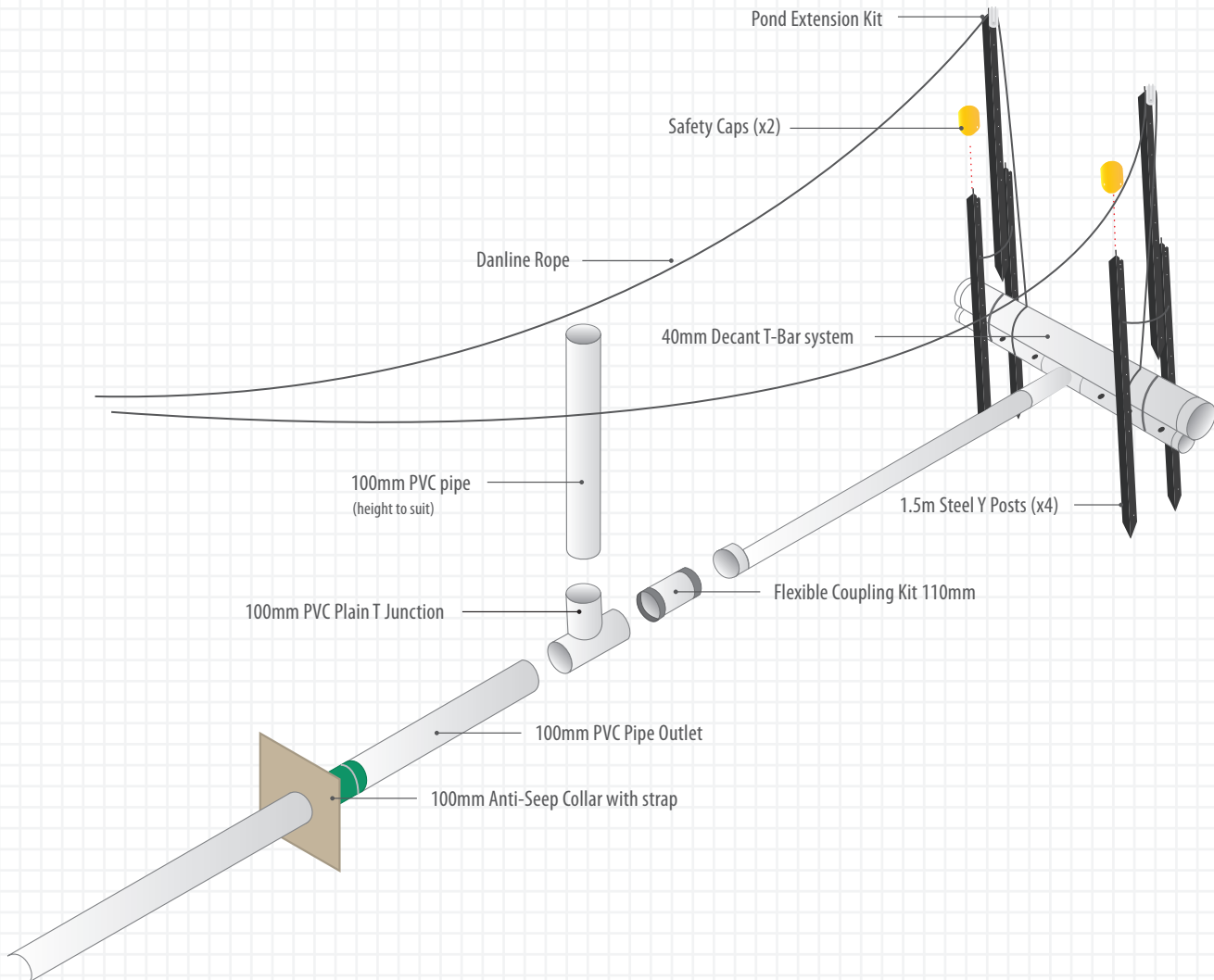

**0 - 0.15HA CATCHMENT**  
Discharge rate = .45ltrs ≤ per sec

## ALSO REQUIRED >

- ✓ EnviroForce
- ✓ DuraForce® WG21
- ✓ Ground Staples 230mm
- ✓ 100mm PVC (customer supply)

## Decant Kit 40mm Components

Code	Product	Size	Qty Req.
13396	Pond Decant T Bar	40mm	1
13283	Flexible Coupling Kit	110mm	1
13194	Pond Extension Kit	1.8m	2
13401	Anti-Seep Collar	100mm	1
76058	Steel Y Posts	1.5m	4
76059	Safety Caps	100/Bag	1
13316	PVC Plain T Junction	100mm	1
13195	Danline 4mm	220m	1



TO ORDER CALL US ON  
**0800 CIRTEX (247 839)**